

**Hatchery
excellence.
Made easy.**

Mission

Now.

Providing the poultry industry with worry-free hatcheries, now and in the future.



Vision

The future.

Aspiring to make poultry protein accessible & affordable globally.



Milestones

The foundation.

Jamesway and Chick Master joined to form one of the largest suppliers of hatchery incubators in the world.

We have never been more dedicated to providing the industry with service, reliability and dependability.

- 1890

Jamesway Founded
- 1903

Jamesway Farm Machinery Develops First Incubator
- 1932

2 in 1 Incubator Standard for Industry
- 1939

Chick Master Founded
- 1945

Automatic Turning System Implemented
- 1959

World's First MS Machine with Laminar Airflow
- 1985

Hatchcom Controller
- 1992

ACI Single-Stage Launched
- 2002

Avida Incubation System with Zone Control
- 2006

Heat Recovery & Energy Management Technology
- 2008

1st Variable Frequency Drive
- 2010

CC3 Climate Control System
- 2013

Platinum 2.0
- 2015

Modular Ventilation
- 2016

ROCK Controls
- 2019

XCM 24V DC (JW)
- 2020

Jamesway & Chick Master Integration
- 2023

Ovation



Trust the numbers.

Our company has over 230 years of combined experience in the business which gives us an incredible depth of knowledge.

Our customer base includes over 2500 hatcheries and includes broilers, breeders, layers, duck, turkey, chicken, vaccine producers and many other uses we never even imagined.

Our companies have over 230 years of combined experience in the business which has given us an incredible depth of knowledge.

Our industry professionals have over 18+ years of hands-on hatchery experience each, on average.

Our support staff is the largest professional staff of any hatchery machine supplier.

We have a large global team of Hatchery Specialist Consultants, many with doctorates in their fields. This team guides us in our machine development and is the foundation for our knowledge base. This is available to all our customers. We also want to help you and your staff with training and seminars; we are continually adding to our extensive library of webinars and videos.

Our machines are robust and long lasting with an average age of 30+ years. They are the solid cornerstones for your hatchery.



The three E's.

Our products are **Easy, Efficient** and **Economical**. All three translate to an improved bottom line.



With Jamesway as your partner you will notice efficiencies in your hatchery **immediately**.

- Machines designed to save energy and labour.
- Software designed to improve processes.
- Equipment built to last.
- Systems for complete climate control.
- An investment in Jamesway machines lasts for decades.
- The relationship does not stop with the installation of the machine.
- We are with you throughout the journey of your hatchery, with industry leading standard warranties and unlimited help and support.

Economies that translate to an improved bottom line.



Ovation: the new standard for single-stage incubation.

The combined knowledge of two hatchery industry giants, Jamesway and Chick Master, has produced the essential incubation machine. **Introducing: Ovation.**

Experience **incredible hatch results and industry leading energy efficiency** in an incubation system designed for intuitive use.



Fully Sealed Cabinet

With no openings for external belts or pulleys the OVATION precisely controls the CO2 levels. You can truly set your program and relax.

Environmental Control

Removable small fan unit allows for complete sanitation. Smaller fans provide excellent uniform air flow and industry leading energy efficiency.



Easy Programming

Large 12" color HMI screen and intuitive interface.

360

Easy Hatchery Management: the new digital platform that unlocks the full potential and power of data in the hatchery.

On Trolley Turning

Our signature pneumatic turning is active on each trolley to ensure a consistent turning angle for every tray.

Higher Heat Loads

Setting larger eggs will result in higher heat production. We have adapted for this situation by increasing cooling coil surface area for a more responsive temperature control, regardless of egg size.

193,000+ Eggs

Choose the Ovation 0-36 machine with a capacity of 36 racks for greater efficiencies in high volume hatcheries. One of the largest machines on the market.



Products: OvationCM

Ovation is also available for the Chick Master single-stage footprint and paddle fan configuration.



On Trolley Turning

Our signature pneumatic turning is active on each trolley to ensure a consistent turning angle for every tray. Simplified mechanics allow for improved performance while reduced surface area ensures a more thorough cleaning, reducing bio security risks.

Paddle Fan Design

Variable frequency drive for adjustable fan speed and improved energy efficiency.

Easy Programming

Large 12" color HMI screen and intuitive interface.

Enhanced Door Seals

Essential for consistent environmental control.

360

Easy Hatchery Management: the new digital platform that unlocks full potential and power of data in the hatchery.

Zonal Control

Up to 4 individual zones per system for accurate control of humidity and airflow dynamics.



Energy Efficiency.

Jamesway has been the industry leader in energy efficient machines for over **20 years**. Our small fan design and completely sealed cabinets make for the best savings, and our customers benefit from an improved bottom line and an accelerated return on investment.

Gain further savings by integrating our specially designed AIRWAY hatchery ventilation systems.

Estimated annual energy costs based on installed power ratings

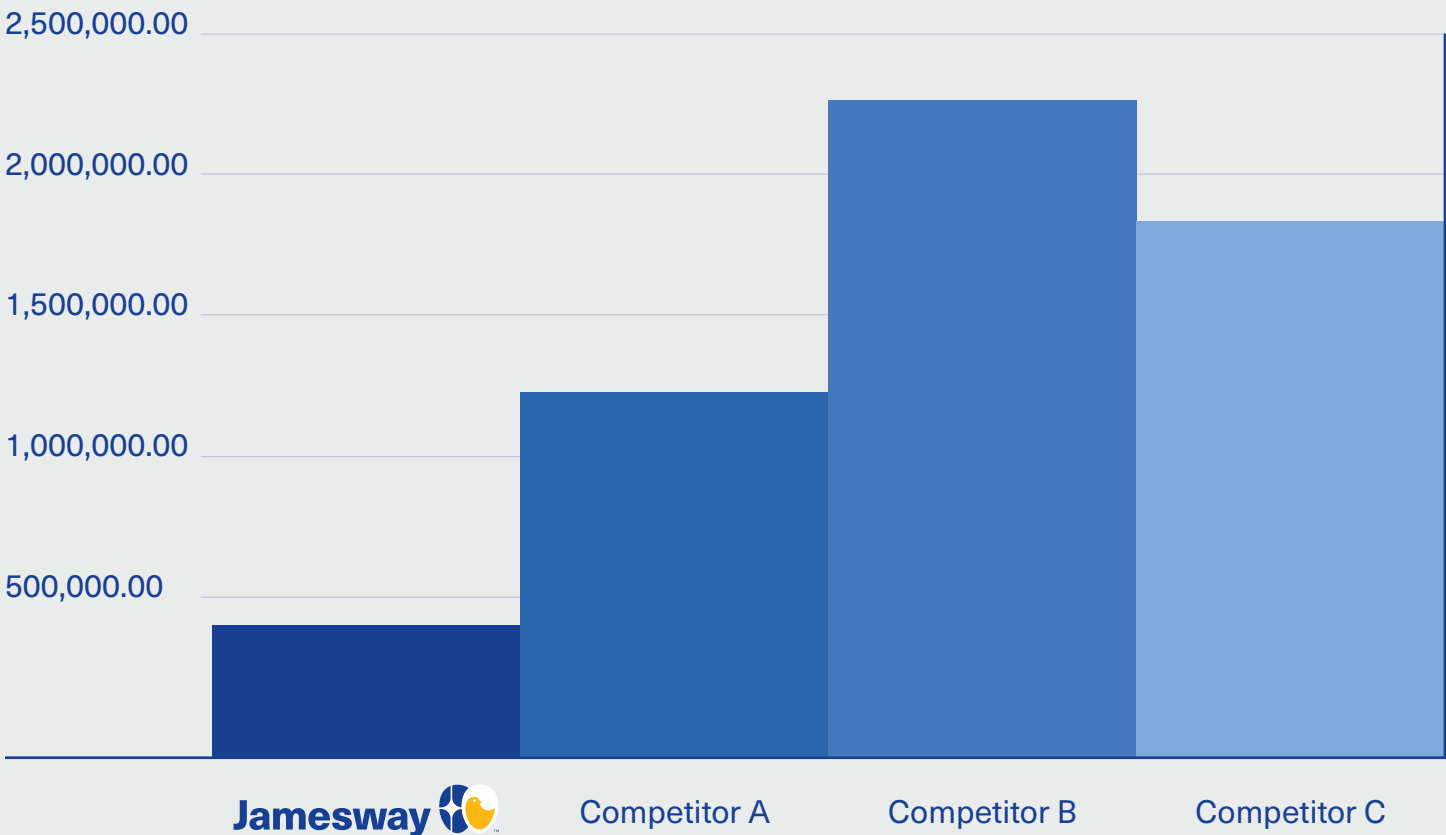

360: Easy Hatchery Management

360: the Future of Hatchery Management.

Unlock the potential of data and realize enhanced hatchery performance.

- Easily customize your staff's access to meet their needs, ensuring they have the correct information to streamline their job.
- Monitor your incubators from anywhere in the world using the Azure cloud platform.
- Build on the core incubation data to create a dynamic preventative maintenance program for each incubator.
- Experience stable, consistent, and reliable conditions that are vital for developing embryos.



Part of the new Ovation machines series

Ovation features our 360 service - the total solution for any modern hatchery operation. 360 provides immediate insight into the performance of your incubators and hatchery systems. Available for all our Single-Stage products.



Products: Multi-Stage Solutions

The Classic.

Sometimes you need an efficient, forgiving and easy to operate setter in your hatchery. The Chick Master Classic has proven to be one of

the best Multi-Stage setters on the market; in some cases giving better results than Single-Stage setters from other brands.

The Ideal Environment

- Unique setting pattern with multiple zone temperature control and high-capacity water cooling create a balanced environment.
- High efficiency fans with plastic blades for uniform airflow and lower energy costs.
- Exhaust system with multiple ports evenly dissipates embryonic heat.
- (see Capacity Chart on last page)



Super J.

In 1959, Jamesway pioneered **Multi-Stage incubation**. Since then we have fine-tuned our technology to ensure that in each stage of development the

embryos receive the proper mixture of heat, moisture, and carbon dioxide to deliver better hatches with higher energy efficiency.

Small Fans

Our Multi-Stage machines use small energy efficient fans that are easy to clean and maintain, and offer superior air flow.

Controls

The Multi-Stage control system is both user friendly and economical. The high-contrast digital LED temperature readouts and status indicators provide quick and easy insight into all critical machine functions.

The PS501 upgrades for older controls are a very popular way to bring your machines up to date.



Hatchery Services

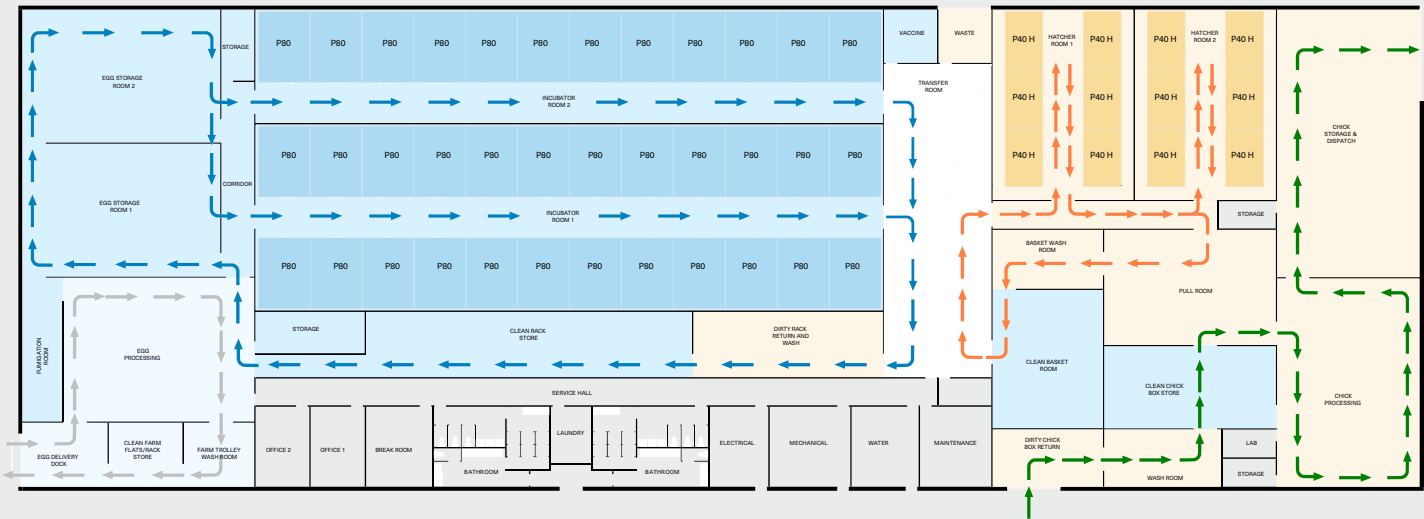

Layouts and Design

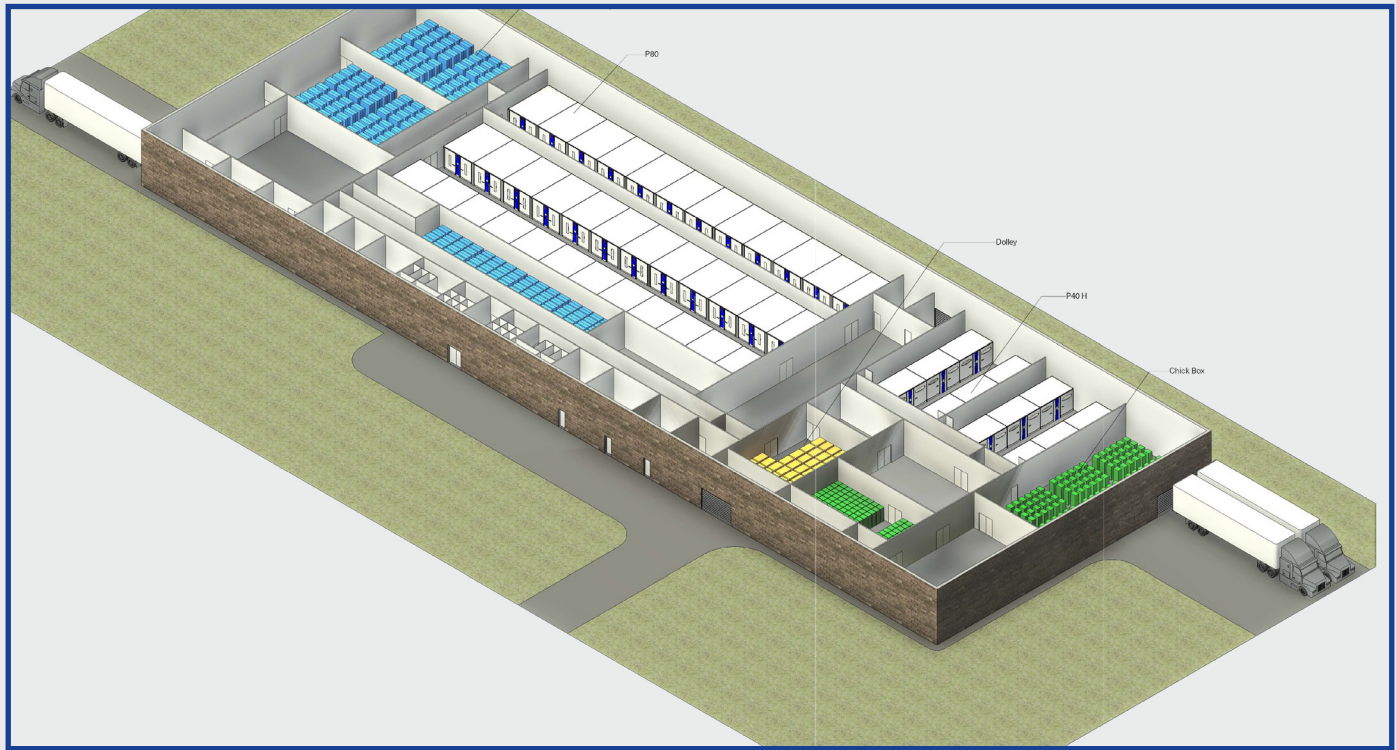

Who is your Partnership Team?

We offer global support for your hatchery. The combined forces of Jamesway and Chick Master have extended our network of warehouses and offices worldwide. Caring for your hatchery is our priority.

It is important to know that your Jamesway Support Network is a team with many components:

- Project Planning and Management Teams
- Installation, Commissioning and Start-Up Teams
- Hatchery Consulting Team
- 24/7 Support Desk and Parts Teams
- Technical Service Team
- Regional Service Managers and a Back-Office Helpdesk
- Regional Sales Teams



Ovation - Setters

Setter	Height	Depth	Width
O-2	2.48m (8'2")	1.42m (4'7")	2.94m (9'8")
O-4	2.48m (8'2")	2.48m (9'4")	2.94m (9'8")
O-8	2.48m (8'2")	2.48m (9'4")	3.91m (12'10")
O-12	2.48m (8'2")	2.48m (9'4")	5.35m (17'7")
O-16	2.48m (8'2")	5.35m (17'7")	3.91m (12'10")
O-24	2.48m (8'2")	5.35m (17'7")	5.35m (17'7")
O-36	2.48m (8'2")	7.895m (25'9")	5.35m (17'7")

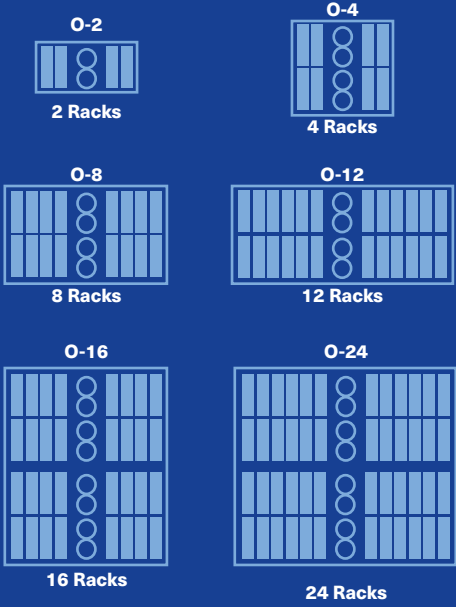

Setter	Egg Flat Cap	O-2	O-4	O-8	O-12	O-16	O-24	O-36
Chicken (16 Tier)	42, 84, 168	10,752	21,504	43,008	64,512	86,016	129,024	193,536
Turkey/Duck (13 Tier)	25	5,200	10,400	20,800	31,200	N/A	N/A	N/A
	30	6,240	12,480	24,960	37,440	N/A	N/A	N/A

Ovation - Hatchers

Hatcher	Height	Depth	Width
O-2H	2.48m (8.2")	1.42m (4'7")	2.84m (9'8")
O-4H	2.48m (8.2")	2.84m (9'4")	2.84m (9'8")
O-6H	2.48m (8.2")	2.84m (9'4")	3.91m (12'10")
O-8H	2.48m (8.2")	2.84m (9'4")	4.40m (14'5")
O-12H	2.48m (8.2")	4.26m (13'11")	4.40m (14'5")

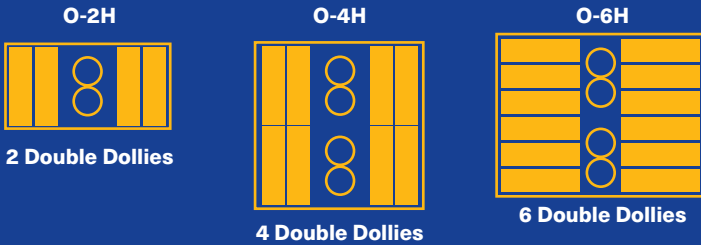

Hatcher	O-2H	O-4H	O-6H	O-8H	O-12H
Chicken	10,752	21,504	32,256	43,008	64,512
Turkey/Duck	6,240	12,480	18,720	24,960	37,440

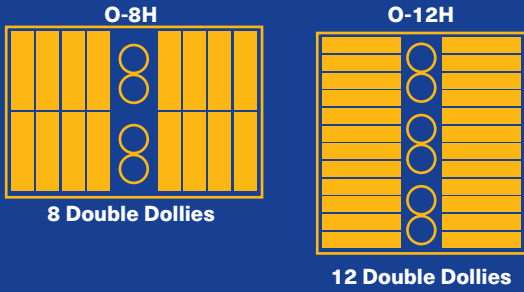

OvationCM - Setters

Setter	Height	Depth	Width
OCM-6	2.83m (9'4")	2.45 (8'1")	3.44m (11'3")
OCM-12	2.83m (9'4")	4.85m (15'11")	3.44m (11'3")
OCM-18	2.83m (9'4")	7.25m (23'9")	3.44m (11'3")
OCM-24	2.83m (9'4")	9.65m (31'8")	3.44m (11'3")

Setter	Egg Flat	OCM-6	OCM-12	OCM-18	OCM-24
Chicken (16-tier)	54	31,104	62,208	93,312	124,416
	165	31,680	63,360	95,040	126,720

OvationCM - Hatchers

Hatcher (16 tier)	Height (16 tier)	Depth	Width
OCM-6H	2.83m (9'4")	2.82m (9'3")	3.44m (11'3")
OCM-12H	2.83m (9'4")	5.59m (18'4")	3.44m (11'3")

Hatcher	OCM-6H	OCM-12H
Chicken (16-tier)	31,680	63,360

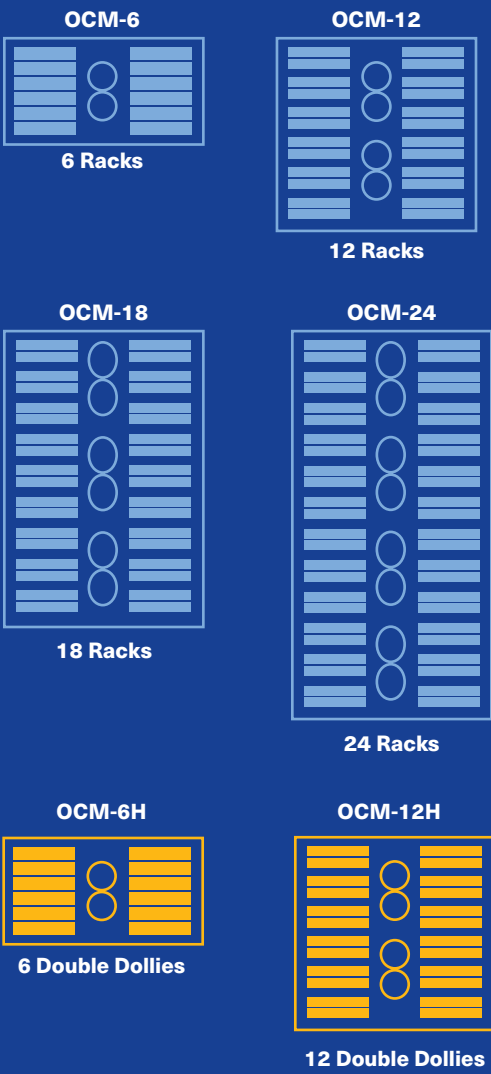

Multi-Stage Solutions

Chick Master Classic: Setters

Setter	Height	Depth	Width
C360	3.03m (9'11")	4.47m (14'8")	3.79m (12'6")
C540	3.03m (9'11")	6.6m (21'8")	3.79m (12'6")
C576	3.03m (9'11")	6.6m (21'8")	3.79m (12'6")
C768	3.03m (9'11")	8.74m (28'8")	3.79m (12'6")

Setter	Egg Flat	C360 24 columns	C540 36 columns	C576 36 columns
Chicken (15-tier)	54	58,320	87,480	N/A
	165	59,400	89,100	N/A
Chicken (16-tier)	54	N/A	N/A	93,312
	165	N/A	N/A	95,040
Setter	Egg Flat	C336T	C504T	
Turkey/Duck (14-tier)	46	46,368	69,552	
	120	40,320	60,480	

Chick Master Classic: Hatchers

Setter	Height	Depth	Width
CV H60	2.54m (8'4")	1.79m (5'10")	2.5m (8'3")
CV H64	2.54m (8'4")	1.79m (5'10")	2.5m (8'3")
CV H90	2.54m (8'4")	1.79m (5'10")	3.39m (11'1")
CV H96	2.54m (8'4")	1.79m (5'10")	3.39m (11'1")

Hatcher	CV H60	CV H64	CV H90	CVH96
Chicken - 54 tray	9,720	10,368	14,580	15,552
Chicken - 165 tray	9,900	10,560	14,850	15,840
Turkey/Duck - 46 tray	7,728*	N/A	11,592*	N/A
Turkey/Duck - 120 tray	6,720*	N/A	10,080*	N/A

Jamesway J Series:

Setter	Eggs Per Flat	Racks Per Cabinet	Weekly Settings	Setter Capacity	Hatcher Capacity
Chicken	42/84/168	12	2	90,720	15,120
Super J	42/84/168	6	1	45,360	15,120
Turkey or Duck	25	8	1	31,200	7,800
	30	8	1	37,440	9,300



Check out our website for more information on Jamesway Chick Master products and services:

www.jamesway.com
www.jameswayparts.com
parts.chickmaster.com

Global Corporate Office

Jamesway Chick Master Incubator Inc.
30 High Ridge Court, Cambridge, Ontario
N1R 7L3, Canada

Tel: 1 519 624 4646
Fax: 1 519 624 5803
sales@jamesway.com

U.S. Office

1093 Medina Road, Suite 600, Medina
OH 44256, USA

Tel: 1 330 722 5591
Fax: 1 330 723 0233

U.K. Office

1 The Leggar, Bridgwater
Somerset, United Kingdom
TA6 4AF
Tel: 00 44 1278 411000

Jamesway 

